

WILKES COUNTY

TYPE OF WORK: MICROSURFACING
MAP # 1

2024

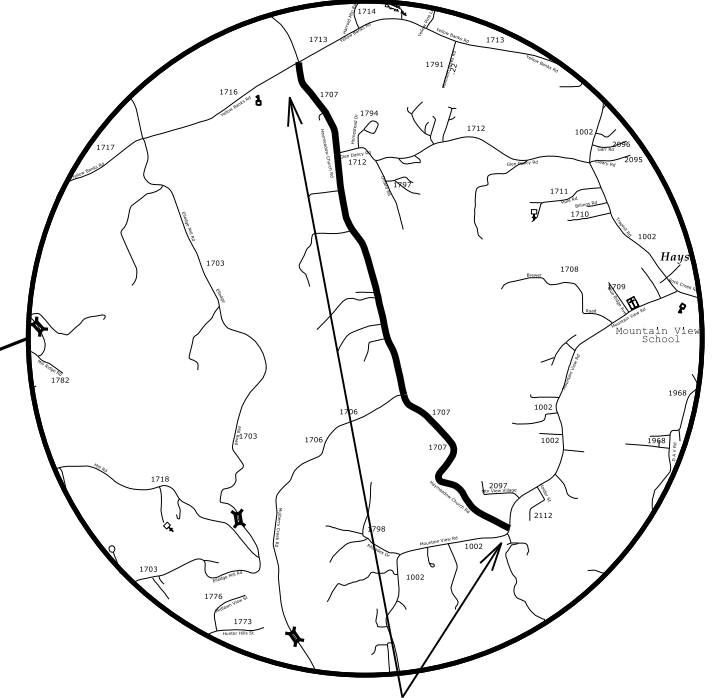
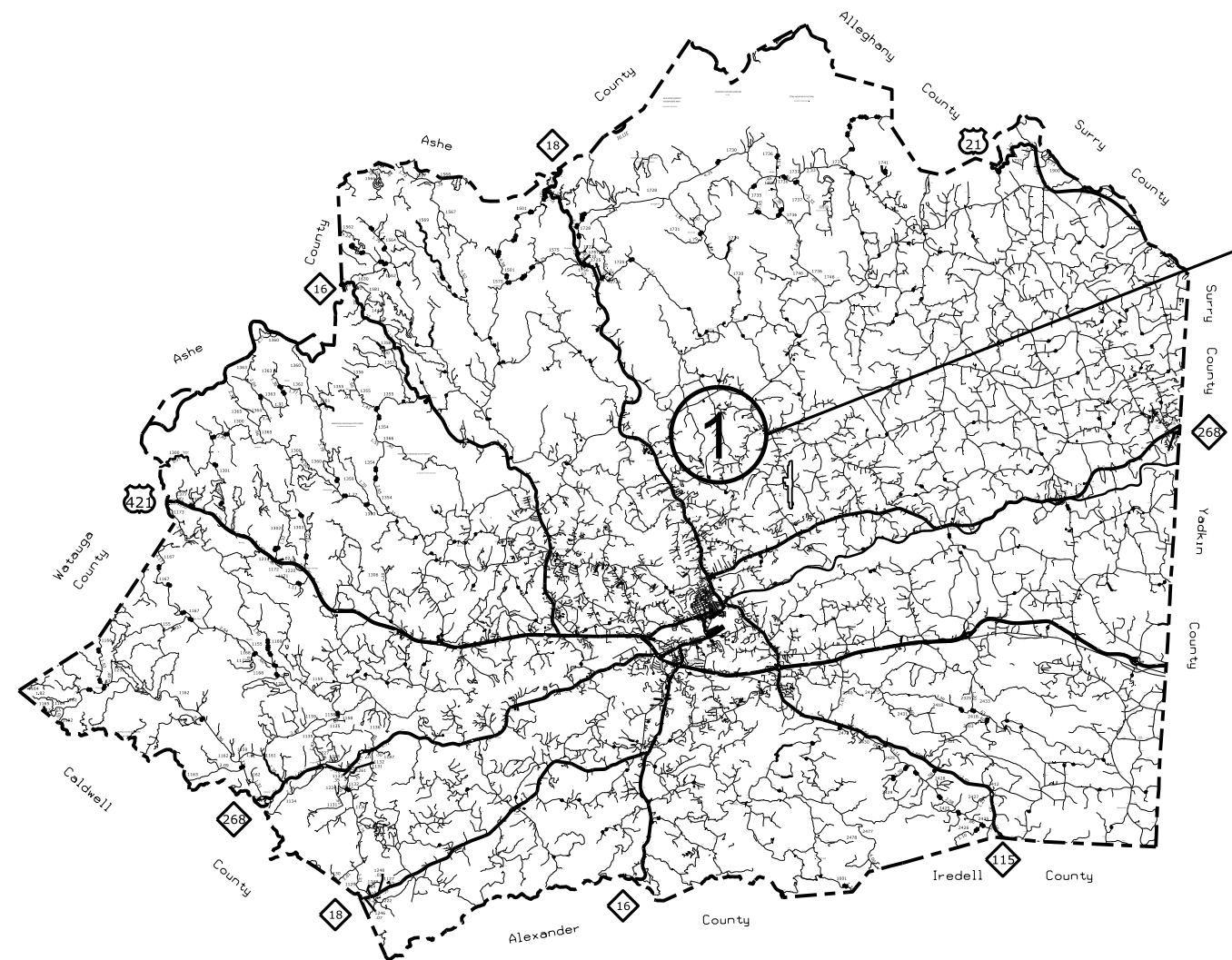
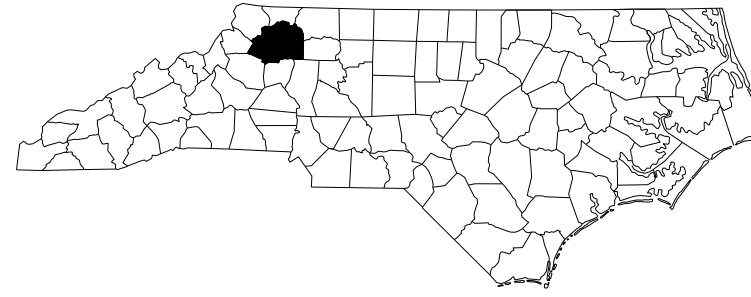

MAP #1

* SR 1707 - (2.54mi.)
(FROM SR 1716 TO SR 1002)

PAVEMENT SCHEDULE	
F1	LATEX MODIFIED MICROSURFACING TYPE II AT AN AVERAGE RATE OF 18 TO 22 LBS. PER SY. YD.
F2	LATEX MODIFIED MICROSURFACING TYPE III LEVELING COURSE AT AN AVERAGE RATE OF 22 TO 26 LBS. PER SY. YD.
U	EXISTING PAVEMENT

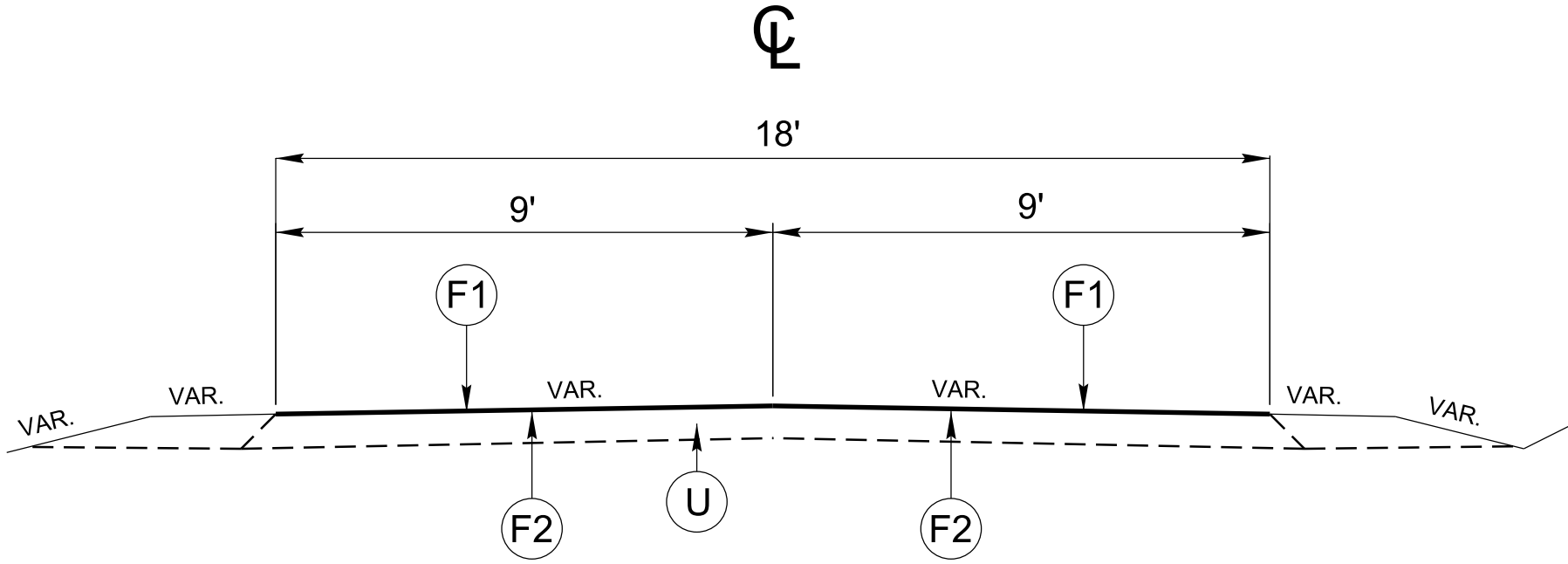

TYPICAL SECTION NO. 1

MAP 1 - SR 1707 HAYMEADOW RD FROM SR 1716 TO SR 1002

NOTE: TYPICALS ARE NOT TO SCALE

WILKES COUNTY
SECONDARY ROAD
2024 MICROSURFACING

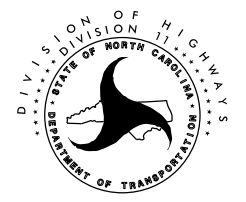

REVISIONS	INIT.	DATE

N.C. DEPARTMENT of TRANSPORTATION
DIVISION of HIGHWAYS
DIVISION ELEVEN

SCALE: N/A DATE: 7/1/2023
 PREPARED BY: RAS
 REVIEWED BY:

05-JUL-2023 10:35
 P:\2024-Resurfacing-Maps\MicroResurfacing - Haymeadow Rd. - Wilkes County\MicroResurfacing2023-Haymeadow Rd.typical.dgn
 \$\$\$SUSERRN\$\$\$

PROJECT NO.	SHEET NO.	TOTAL NO.
2023CPT.11.23.20972		

SUMMARY OF QUANTITIES

PROJECT NO	COUNTY	MAP NO	ROUTE	DESCRIPTION	TYP NO	LANES	LANE TYPE	Begin Milepost	End Milepost	LENGTH	WIDTH	188000000-E	188200000-E	189100000-E
												GENERIC PAVING ITEM, AGGREGATE, TYPE III	GENERIC PAVING ITEM, LATEX MODIFIED EMULSION	LATEX MODIFIED MICROSURFACING, TYPE II, SURFACE COURSE
											TON	GAL	SY	
2023CPT.11.23.20972	Wilkes	1	SR-1707 / HAYMEADOW RD	FROM SR 1716 TO SR 1002		2		0	2.54	2.54	18	325	9,140	29,500
TOTAL FOR PROJ NO. 2023CPT.11.23.20972											325	9,140	29,500	
GRAND TOTAL											325	9,140	29,500	

THERMOPLASTIC AND PAINT QUANTITIES

PROJECT NO	COUNTY	MAP NO	ROUTE	DESCRIPTION	TYP NO	LANES	LANE TYPE	LENGTH	WIDTH	441300000-E	445700000-N	481000000-E		485000000-E	
										WORK ZONE ADVANCE/GENERAL WARNING SIGNING	TEMPORARY TRAFFIC CONTROL	4" WHITE PAINT	4" YELLOW PAINT	REMOVAL OF PAVEMENT MARKING LINES (4")	
											SF	LS	LF	LF	LF
2023CPT.11.23.20972	Wilkes	1	SR-1707 / HAYMEADOW RD	FROM SR 1716 TO SR 1002		2		2.54	18	330	1.00	54,661	54,661	54,661	
TOTAL FOR PROJ NO. 2023CPT.11.23.20972											330	1.000	54,661	54,661	54,661
GRAND TOTAL											330	1.000	54,661	54,661	54,661

SIGNING FOR RESURFACING PROJECTS

LEGEND
 ┃ STATIONARY SIGN
 ← DIRECTION OF TRAFFIC FLOW

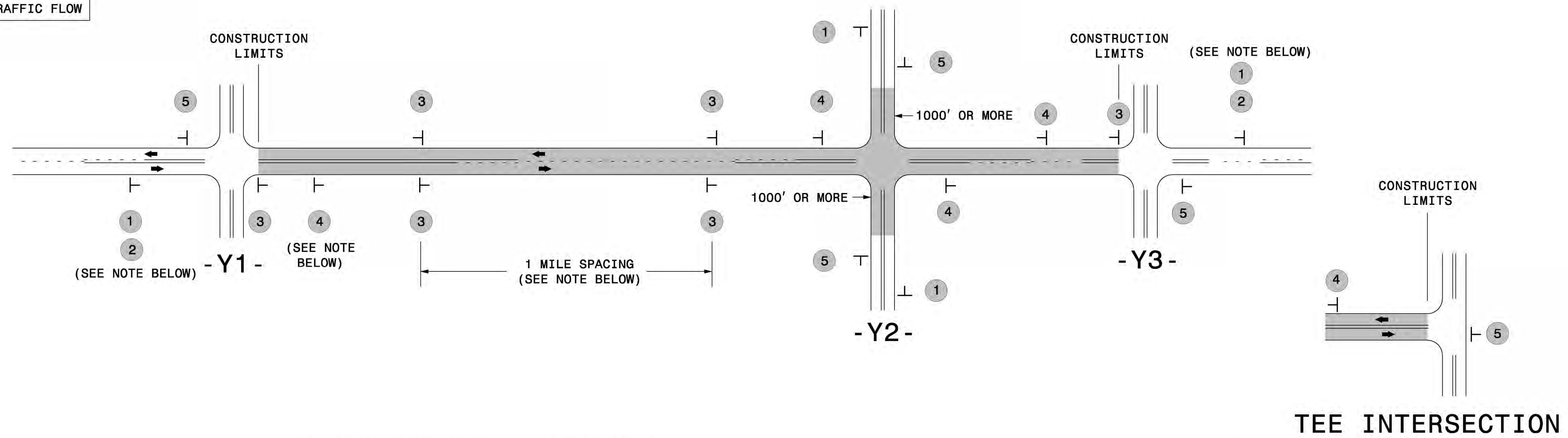

MAINLINE (-L-) SIGNING

-Y- LINE SIGNING

SIGNING NOTES AND PLACEMENT PER DIRECTION	1		PLACE 1000' PRIOR TO BEGINNING OF CONSTRUCTION LIMITS. ONLY USED ON -Y- LINES IF RESURFACING LIMITS EXTEND 1000' ALONG -Y- LINE.	<p>NO REQUIRED STATIONARY SIGNING FOR THE FOLLOWING -Y- LINE CONDITIONS:</p> <ol style="list-style-type: none"> 1) LESS THAN 1000' OF RESURFACING ALONG -Y- LINE 2) SUBDIVISION ROADS 3) DEAD END ROADS <p>WHEN PAVING/CONSTRUCTION ACTIVITIES PROCEED ACROSS AN UNSIGNED -Y- LINE, PORTABLE ADVANCE WARNING SIGNS SHALL BE USED ALONG THE -Y- LINE AS SHOWN BELOW. REMOVE UPON COMPLETION OF WORK.</p> <div style="display: flex; justify-content: space-around;"> <div style="text-align: center;"> PLACED 500' IN ADVANCE OF FLAGGER. </div> <div style="text-align: center;"> PLACED 250' IN ADVANCE OF FLAGGER. </div> </div>
	2		#2 SIGN ONLY USED WHEN CONSTRUCTION LIMITS ARE 2 OR MORE MILES IN LENGTH. ROUND UP TO NEXT WHOLE NUMBER. (NO FRACTIONAL OR DECIMAL NUMBERS)	
	3		- PLACE INITIALLY AT THE CONSTRUCTION LIMITS AND SPACE 1 MILE APART THEREAFTER. - AT TEE INTERSECTIONS INSTALL INITIALLY 1/2 MILE FROM INTERSECTION AND SPACE 1 MILE APART THEREAFTER.	
	4		- THESE ARE FOR -Y- LINES THAT ARE "THROUGH" ROADWAYS. - DEAD END AND SUBDIVISION ROADS ARE NOT "THROUGH" ROADWAYS. - INSTALL 500' +/- FROM EACH -Y- LINE APPROACH AS SHOWN ABOVE. - FOR MULTIPLE -Y- LINES THAT ARE SEPARATED BY 0.25 MILES OR LESS, TREAT AS A SINGLE UNIT AND INSTALL WITHIN 500' OF EACH APPROACH. - A MAXIMUM OF 2 SIGN SETS PER MILE. DO NOT INSTALL WHEN -Y- LINES ARE WITHIN 0.5 MILES FROM "END ROAD WORK" SIGN. - FOR TEE INTERSECTIONS, INSTALL WITHIN 500' +/- OF THE INTERSECTION ALONG -L- LINE.	
	5		PLACE 500' FOLLOWING THE END OF CONSTRUCTION LIMITS OR AS SHOWN WHEN WORK ENDS AT A 3-WAY TEE INTERSECTION.	

THE ABOVE SIGNS ARE ALL THAT ARE REQUIRED FOR A CONTRACTOR TO BEGIN A RESURFACING CONTRACT. ANY ADDITIONAL SIGNS REQUESTED BY NCDOT DIVISIONS SHALL BE INSTALLED WITHIN 7 BUSINESS DAYS OF THE START OF CONTRACT WORK.

MAPS LESS THAN 2 MILES

FOR RESURFACING MAPS WITH CONSTRUCTION LIMITS LESS THAN 2 MILES IN LENGTH, NO STATIONARY SIGNS ARE REQUIRED. USE PORTABLE "ROAD UNDER CONSTRUCTION" OR "ROAD WORK AHEAD" SIGNS IN LIEU OF STATIONARY ADVANCE WARNINGS SIGNS.

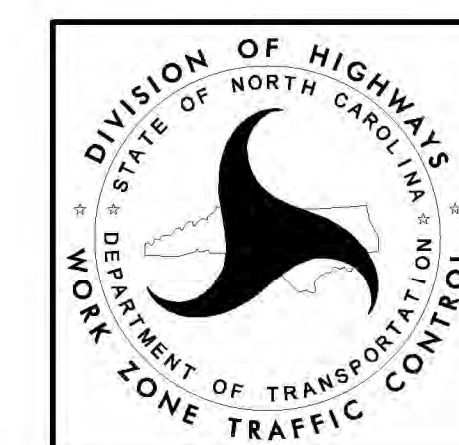

ADVANCE WARNING SIGNS FOR RURAL AND SUBURBAN 2-LANE ROADWAY RESURFACING

5/15/2017 5:11:10 PM \\NCDOT\Users\resurfacing\2122W & AST Resurfacing Details\Resurfacing_AdvWarn_2122.dgn User:keads